

# Model 308

## 测力传感器 / 称重传感器



- 可校准
- 高度密封
- 高精度
- 抗侧向力
- 使用方便

TesT 公司的307系列剪切梁传感器，常用于工业称重。传感器具有高抗侧向力能力，可在恶劣工业环境中进行高精度测量。我们还可以提供特殊规格的不锈钢传感器，可根据 *OIML IR 60* 标准进行校准。

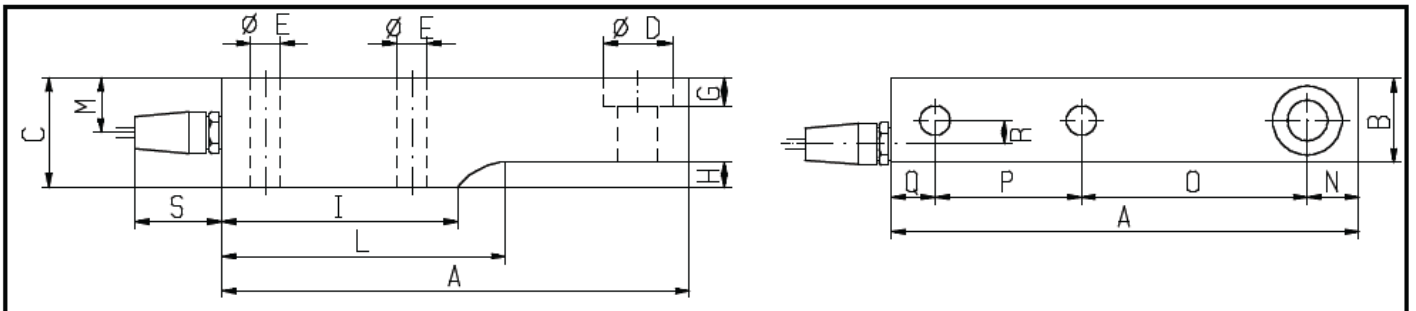

Series	Class	308	308.C2	Range in t		
		H	2000d	Dimensions in mm		
Max. number of verification parts	d	2000		1	5	10
Minimum number of verification parts for	V <sub>min</sub>	7500		2		
Nominal sensitivity	mV/V	2		3		
Sensitivity tolerance	%	± 0,1				
Zero point tolerance	%	± 1				
Zero point tolerance after 30 min	%	± 0,025				
Minimum range	%	27				
Nonlinearity	%	± 0,015				
Variation	%	± 0,02				
Combined error	%	± 0,05   ± 0,024				
Reference temperature	°C	23		A	203,0	235,0
Nominal temperature range	°C	-10...+40		B	36,5	47,6
Running temperature range	°C	-20...+70		C	47,5	70,0
Creep error after 30 min	%	± 0,024		D	∅ 30,0	∅ 41,0
Creep error after 20 min	%	± 0,007		E	∅ 13,0	∅ 22,5
Temperature coefficient of the zero signal per 10K within the nominal temperature	%	± 0,014		F	∅ 17,5	∅ 25,5
Temperature coefficient of the sensitivity per 10K within the nominal temperature	%	± 0,01		G	12,0	16,0
Stock temperature range	°C	-20...+80		H	11,0	22,0
Output resistance at reference temperature	W	350 ± 2		I	102,0	118,0
Input resistance at reference temperature	W	400 ± 25		L	124,5	140,0
Isolation resistance at reference temperature	GW	> 5		M	24,0	24,0
Maximum input voltage	V	18		N	22,5	24,0
Nominal range of input voltage	V	5...15		O	98,0	124,0
Break load in reference to nominal load	%	> 300		P	63,5	66,5
Max. allowance for dynamic load	%	50		Q	19,0	20,5
Max. allowance for traverse load	%	100		R	10,2	15,8
Protection class		IP 67		S	34,0	34,0
Material		NIRO-Stahl				
Weight	kg	2 ; 4,9 ; 8,2				

